

7.3 MAINTENANCE

7.3.1 Replacing the Batteries

The position data of each axis is preserved by the backup batteries. Please use the following procedure to replace when the backup battery voltage drop alarm occurs.

Procedure of replacing the battery (Under consideration)

- 1 Keep the power on. Press the EMERGENCY STOP button to prohibit the robot motion.



CAUTION

Be sure to keep the power on. Replacing the batteries with the power supply turned off causes all current position data to be lost. Therefore, mastering will be required again.

- 2 Remove the bolts and the J2 arm root side cover.
- 3 Remove the cable connector of the batteries.
- 4 Remove bolts and cover plate of the battery.
- 5 Take out the old batteries (2 pcs) from the battery case. Then replace the batteries (2 pcs).
- 6 Assemble them by reversing the sequence. The gasket is reusable.

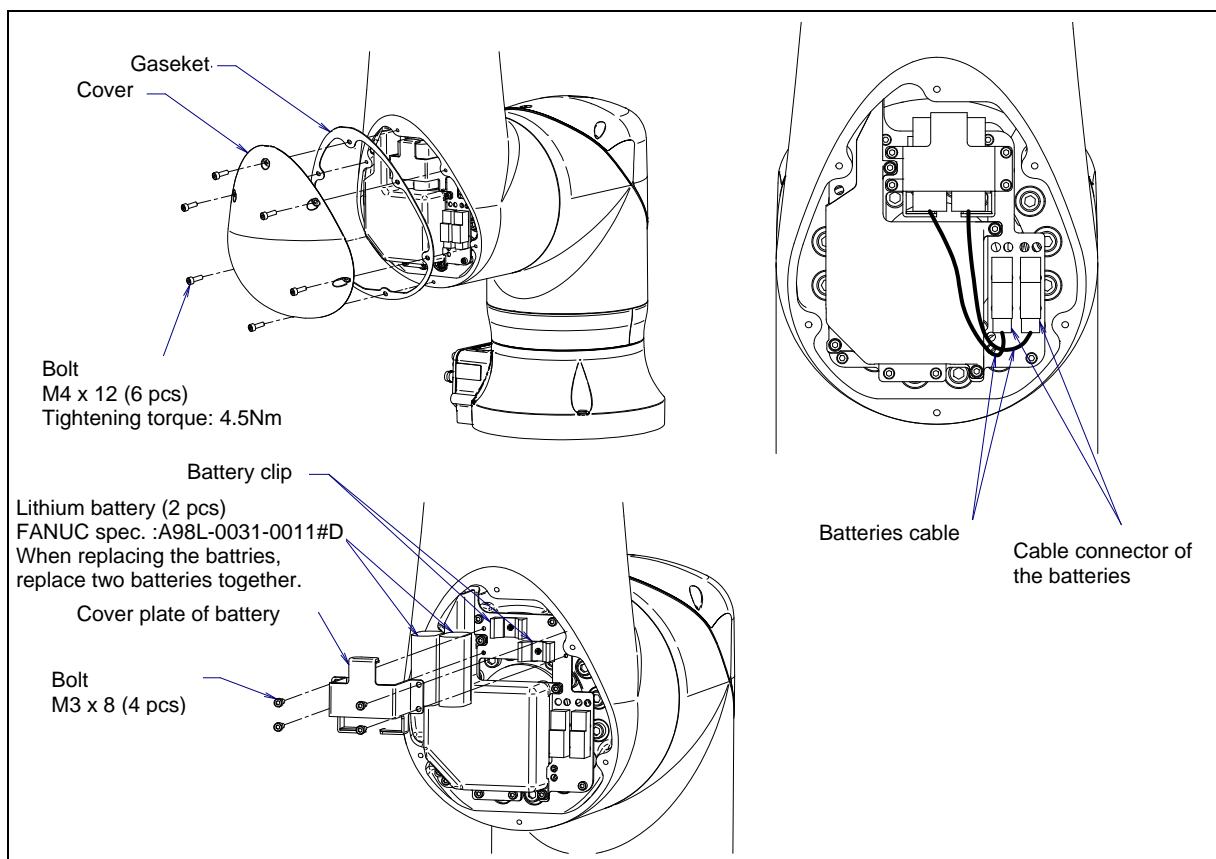

Fig. 7.3.1 (a) Replacing the battery

7.4 STORAGE

When storing the robot, place it on a level surface with the same posture for transportation. (See Section 1.1.)